

NET-1711VD4N

Socket 478 SBC with VGA/SSD/4 GbE

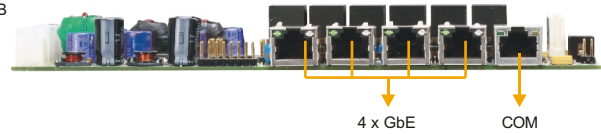
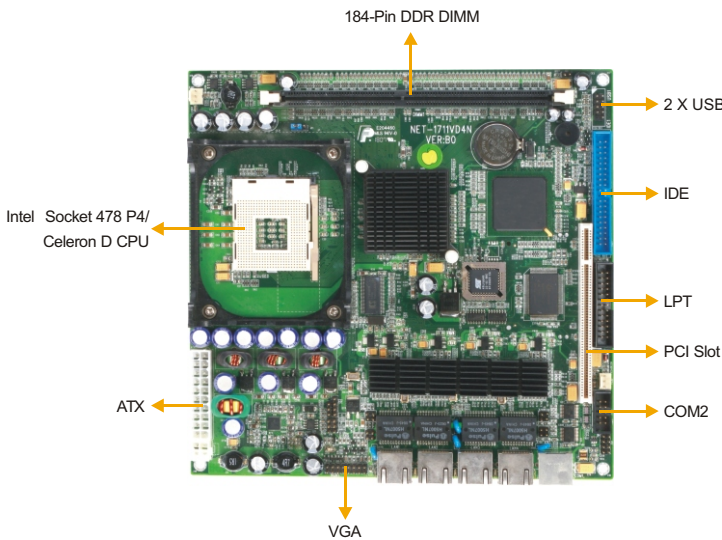

FEATURES

- Socket 478 architecture, Pentium 4 / Celeron / Celeron D CPU supported
- Intel 845GV and ICH4 chipset, stable and reliable
- Four Intel 82541GI 1000M Ethernet controllers onboard
- System BIOS design guarantees the priority of 4-channel network resources
- Hardware monitor function
- PCI and CF card slots

SPECIFICATIONS

Product Bus: Network Application SBC

Bus Type: NET SBC

Processor: Socket 478, 400/533MHz FSB, Pentium 4 / Celeron / Celeron D CPU

Chipset: Intel 845GV chipset

Memory: 1 x 184-pin DDR-DIMM slot, memory up to 1GB

BIOS: AMI 4M BIT FLASH ROM, ARM supported

Onboard Video: Intel 845GV north bridge chip embeds AGP 4X display controller, sharing 32/64MB video memory

Network: 4 x Intel 82541 10M/100M/1000Mbps network chip controller, RJ-45 interface, Wake-on-LAN supported

Network Status Indicator: 4-channel network link status, 4-channel network activity status, 4-channel network speed GbE, LED output

HDD Interface: 1 x ATA 33/66/100 IDE controller, connecting two IDE devices

I/O Interface: 1 x PS/2 keyboard/mouse interface, 2 x RS-232 (1-channel RJ-45 interface), 2 x USB 2.0, 1 x parallel port

Flash Storage: 1 x Compact Flash socket

Hardware Monitor: Real-time monitors voltage, fan speed, CPU temperature, etc., integrating power LED onboard (indicating two kinds of status)

Expansion Bus: 1 x PCI slot

Power Supply: ATX power supply

Dimensions: 203mm x 196mm

Operating Temperature: 0°C~60°C

Operating Humidity: 5%~90%, non-condensing

PACKING LIST

- One NET-1711VD4N motherboard
- One User Manual
- One AMI BIOS Setup Guide
- One IDE cable(80-pin)
- One 9-pin serial port (needle type)and 25-pin parallel port (hole type) converter cable
- One mini-DIN one-to-two PS/2 keyboard/mouse converter cable
- One set of USB converter cable (2.0mm) with bracket
- One CRT converter cable
- One EVOCD including software and User Manual
- Spare jumper

DIMENSIONS

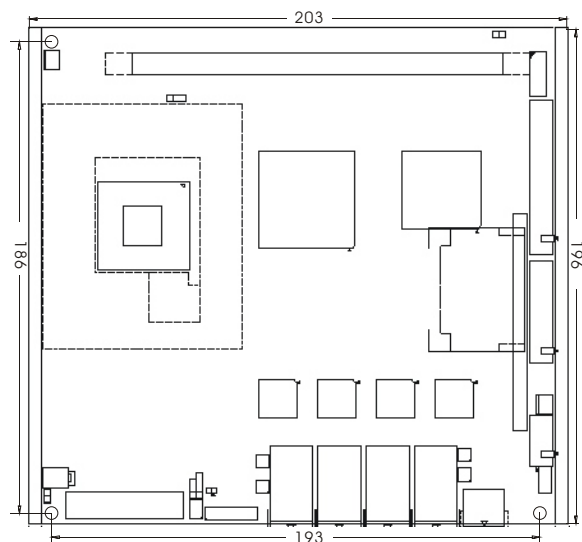

ORDERING INFORMATION

Model Number	Description
NET-1711VD4N	Socket 478 SBC with VGA/SSD/4LAN